

SPECIAL NOTES:-
 1. THIS STRUCTURAL DRAWING IS VALID IF THE CONSTRUCTION IS DONE USING AAC BLOCKS FOLLOWING PROPER DIMENSION OF EXTERNAL AND INTERNAL WALLS AS PER ARCHITECTURAL DRAWING.
 2. THE STRUCTURE MUST BE CONSTRUCTED IN PRESENCE OF A COMPETENT STRUCTURAL ENGINEER FOR STRICT SUPERVISION.

SCHEDULE OF S1 & S2 MARKED SLABS (1ST, TYPICAL FLOOR & ROOF SLABS THICKNESS-115mm & 150mm.)

BAR MKD.	REINFORCEMENT	POSITION
A	8 ϕ @ 150 mm C/C (ALL THROUGH)	BOT.
B	8 ϕ @ 150 mm C/C (ALL THROUGH)	BOT.
X	8 ϕ @ 150 mm C/C (ALL THROUGH)	BOT.
Y	8 ϕ @ 150 mm C/C (ALL THROUGH)	BOT.
C	8 ϕ @ 150mm C/C (CURTALMENT)	TOP
D(BINDER)	8 ϕ @ 200 mm C/C (WHEREVER REQUIRED)	TOP

SCHEDULE OF S3 MARKED SLABS (MUMTY & LMR ROOF SLAB THICKNESS-115mm.)

BAR MKD.	REINFORCEMENT	POSITION
E	8 ϕ @ 150 mm C/C (ALL THROUGH)	BOT.
F	8 ϕ @ 150 mm C/C (ALL THROUGH)	TOP

SCHEDULE OF S4 MARKED SLABS (LMR FLOOR & WATER TANK SLAB THICKNESS-150 mm.)

BAR MKD.	REINFORCEMENT	POSITION
E	10 ϕ @ 200 mm C/C (ALL THROUGH)	BOT.
F	10 ϕ @ 200 mm C/C (ALL THROUGH)	TOP

TYPICAL DETAILS OF SLAB REINFORCEMENT (TOP & BOTTOM)
 (SLAB MARKED S3 & S4)
 (SCALE-N.T.S)

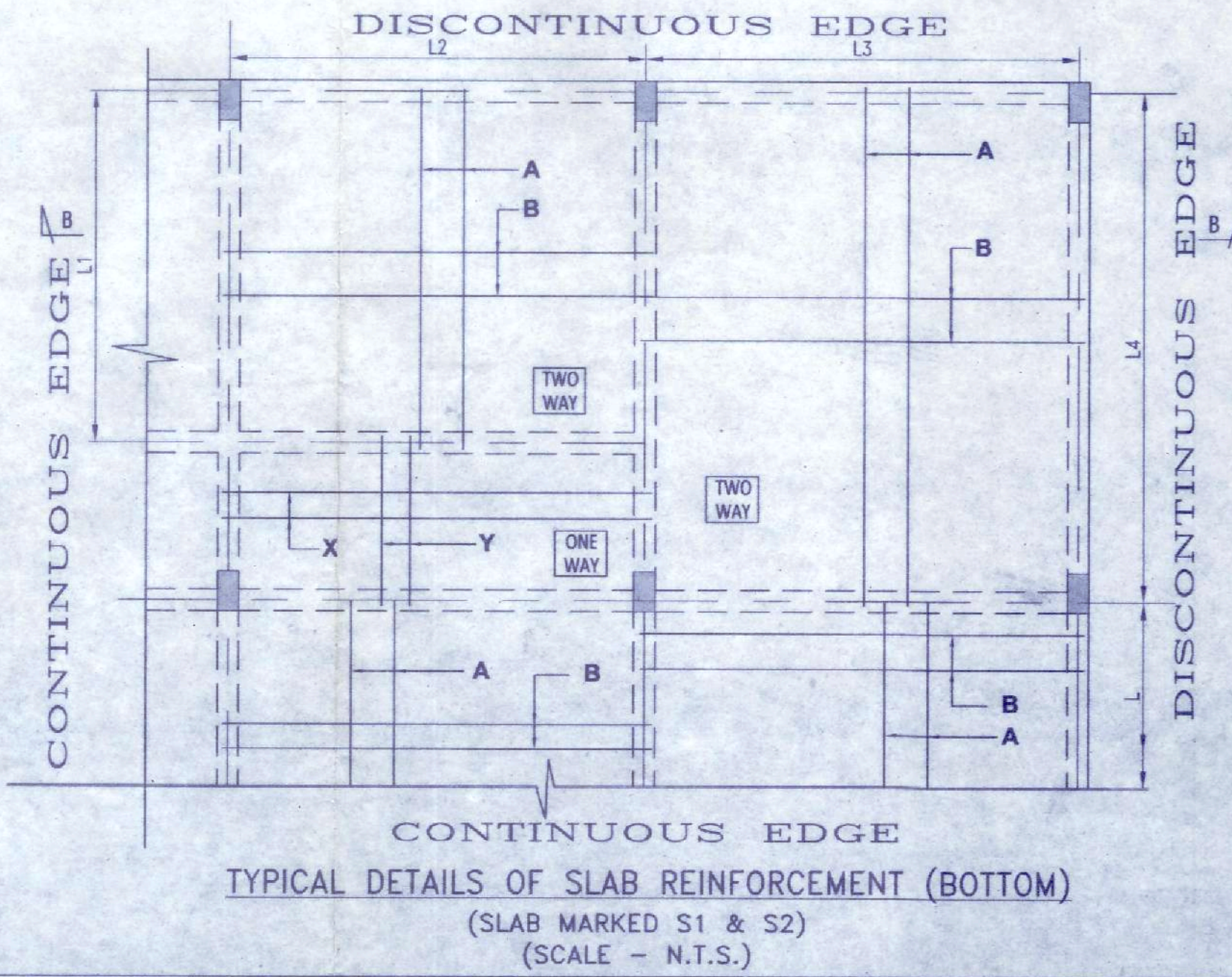
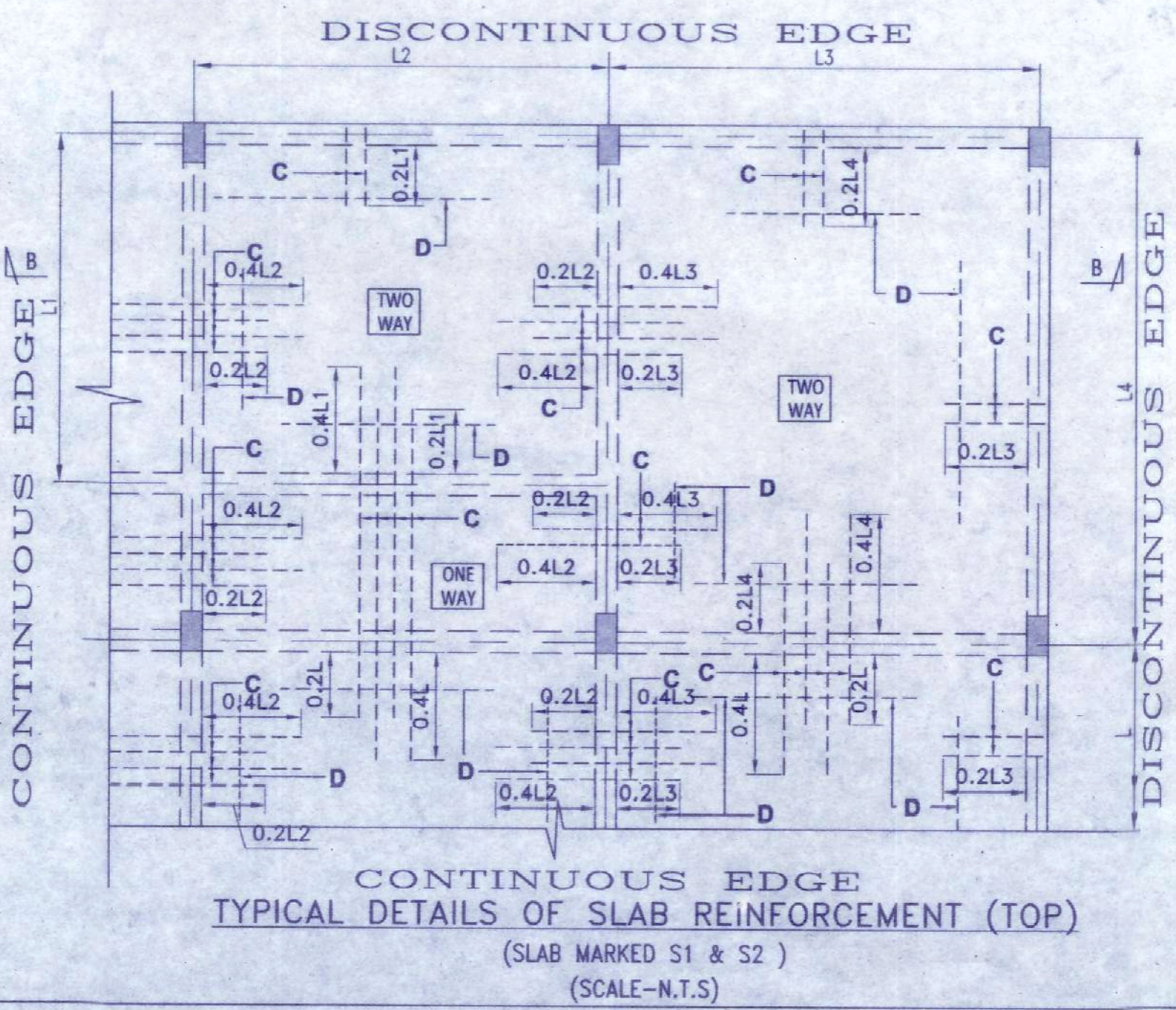
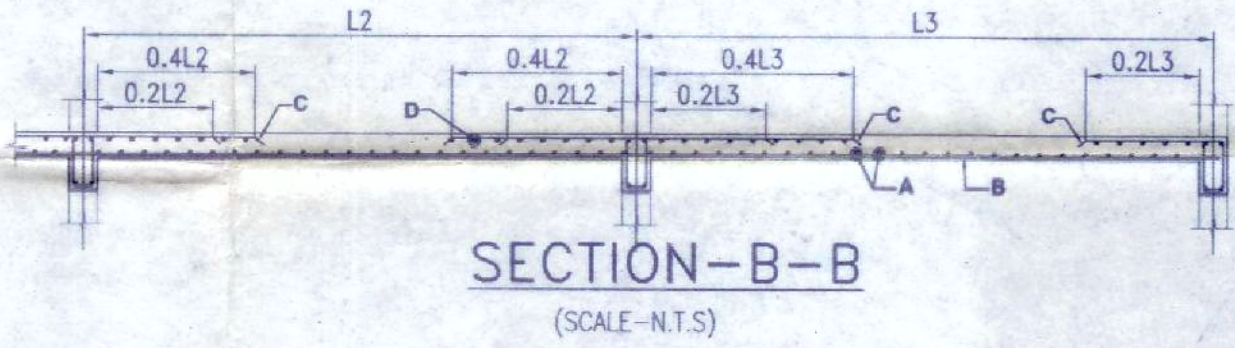

- NOTES :**
- UNLESS OTHERWISE STATED ALL CONSTRUCTION ACTIVITIES SHALL BE CARRIED OUT CONFORMING TO RELEVANT (INDIAN) STANDARD CODES OF PRACTICE.
 - ALL DIMENSIONS ARE IN MILLIMETERS & LEVELS ARE IN METER. EXCEPT OTHERWISE MENTIONED ONLY WRITTEN DIMENSIONS SHALL BE FOLLOWED. ALL LEVELS GIVEN IN STRUCTURAL DRAWINGS ARE IN ACCORDANCE WITH ARCHITECTURAL DRAWINGS AND INDICATE STRUCTURAL LEVEL ONLY (WITHOUT FINISH).
 - ANY DISCREPANCY IN THE STRUCTURAL AND ARCHITECTURAL DRAWINGS SHALL BE BROUGHT TO THE NOTICE OF STRUCTURAL CONSULTANT BEFORE EXECUTION OF WORK.
 - UNLESS OTHERWISE SPECIFIED ALL REINFORCEMENT TO BE USED SHALL BE TMT BARS OF GRADE Fe-500/5000 CONFORMING TO IS-1786-2008.
 - UNLESS OTHERWISE STATED LAP LENGTH OF BARS SHALL BE EQUAL TO THE DEVELOPMENT LENGTH = 50xBAR DIA. CONCRETE NOMINAL COVER TO MAIN REINFORCEMENT SHALL BE AS FOLLOWS:
 i) COLUMNS : 40 mm
 ii) BEAMS : 30 mm
 iii) SLABS : 20 mm
 iv) WAIST SLAB : 20 mm
 - GRADE OF CONCRETE FOR SUPERSTRUCTURE UP TO AND INCLUDING 4TH FLOOR WILL BE M30, ABOVE THAT WILL BE M25 AS PER IS:456:2000.
 - VIBRATOR SHALL BE USED FOR PROPER COMPACTION OF CONCRETE AND CURING SHALL BE DONE PROPERLY. DEVELOPMENT LENGTH 50XD FOR LAP & SPLICES SHOULD BE PROVIDED AS PER THE PROVISIONS LAID DOWN IN SP34:1987
 - WHEREVER A SUPPORTED MEMBER TERMINATES AT A SUPPORTING MEMBER THE BARS OF THE SUPPORTED MEMBER SHOULD HAVE AN ANCHORAGE OF 60D IN THE SUPPORTING MEMBER.
 - WHEN TWO BEAMS MEET AT A COLUMN LOCATION ALONG THE SAME LINE THE HIGHER REINFORCEMENT AT THE TOP SHOULD BE CONTINUED AT BOTH SIDE.

TITLE (BLOCK-3)
 STRUCTURAL DRAWING OF PROPOSED G+10 STORIED (BLOCK -3) APARTMENT BUILDING OF 'SAMPRITHI HEALTHCARE INTERNATIONAL PVT. LTD.' OVER L.R. PLOT NO. - 431, 432, 433, 434 & 437, R.S. PLOT NO. - 433, 434, 435, 437 & 512, KHATIAN NO. - 974, MOUZA - GOPALMATH, J.L. NO- 003, P.S. - DURGAPUR, DIST- PASCHIM BARDHAMAN. HOLDING NO.- N/9, I D NO.- 3309401132148, CIRCLE/ WARD NO- 35, ADDRESS. - G.T. ROAD, GOPALMATH, DGP - 17

SIGNATURE OF OWNER
 SAMPRITHI HEALTHCARE INTERNATIONAL PVT. LTD.
Authorised Signatory

SIGNATURE OF ARCHITECT
Vijaya Singh
 Ar. VIJAYA SINGH MAZUMDER
 COA Registered CA/2021/134276
 COA REGISTERED 9332802166 / 9476426106
 CA/2021/134276

SIGNATURE OF GEOTECHNICAL ENGINEER

SIGNATURE OF STRUCTURAL ENGINEER
Susmita Choudhury
 SUSMITA CHOUDHURY
 B.TECH (CIVIL) - WBUT
 ME (CONSTRUCTION) - JU
 ESE-I/RJPSON/130
 ESE-II/KMC/664
 STER/NKDA/21/00010
 CVER/NKDA/10/00175
 (M)- 8697517321/7003201735

SIGNATURE OF THE VETTING AUTHORITY
 CHECKED & VETTED
Dr. Dipankar Chatterjee
 DR. DIPANKAR CHATTERJEE
 STRUCTURAL ENGINEERING DESIGN
 PROFESSOR & FORMER HEAD
 CIVIL ENGINEERING DEPARTMENT
 JADAVPUR UNIVERSITY
 B.E.(U.) GOLD MEDALIST
 M.TECH (ITKGP) GOLD MEDALIST
 Ph.D. (IIT KGP)
 (C/P) 033-2487 2689
 (M) 9830188502 & 9833093143
 EMAIL - Prof.dipankar@gmail.com

STRUCTURAL CONSULTANT:
 STRUCTCON ENTERPRISE
 REGD. ADDRESS: ASHRAY APARTMENT,
 GROUND FLOOR
 98B, KALIKAPUR ROAD,
 KOLKATA- 706 099
 EMAIL - structconenterprise@gmail.com

DRAWING TITLE
 REINFORCEMENT DETAILS OF SLAB.
 SCALE-1:100 OR AS SHOWN
 DATE-18.05.2022
 SHEET NO. - 5 OF 5 SHEET SIZE - A2